

## aurora Always Ready Smart Bulb Dimmer

The Lutron aurora always ready smart bulb dimmer is a flexible and easy-to-use device that provides convenient control of compatible Zigbee® bulbs. This battery-operated remote control requires no wiring. The remote is designed to attach to your existing toggle-style switch; locking it in the ON position so the bulbs stay connected, while providing control to the user where expected.

### Features

- Provides instant and direct control of compatible bulbs that utilizes a 2.4 GHz, Zigbee® 3.0 or Zigbee® Light Link wireless technology. The complete list of compatible bulbs can be found at [www.lutron.com/SmartBulbDimmers](http://www.lutron.com/SmartBulbDimmers)
- Philips® Hue® bridge certified for use in a Hue® bridge system.\*
- Provides direct dimming control of Philips® Hue® lamps without the need for a hub, bridge, or smartphone.
- Clean look; hidden LED illuminates to provide feedback of successful communication.
- Quickly attaches to most common toggle switches to keep the lighting control where you expect it, while ensuring the connected bulbs stay connected.
- Control up to 12 connected bulbs per remote control in standalone, i.e. without a system bridge.
- Battery-powered. Requires no wiring.
- 3 year battery life\*\* (one CR2032 battery included).
- Rotary style provides intuitive, familiar control of your lights.
- Prevents light switch from being turned OFF; keeps connected bulbs ready to be controlled.
- Low battery indication LED.
- Multi-location capable without a bridge.

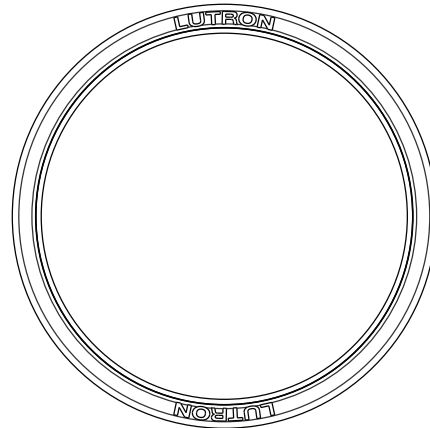

aurora Always Ready Smart Bulb Dimmer

### Attaches easily to toggle switches

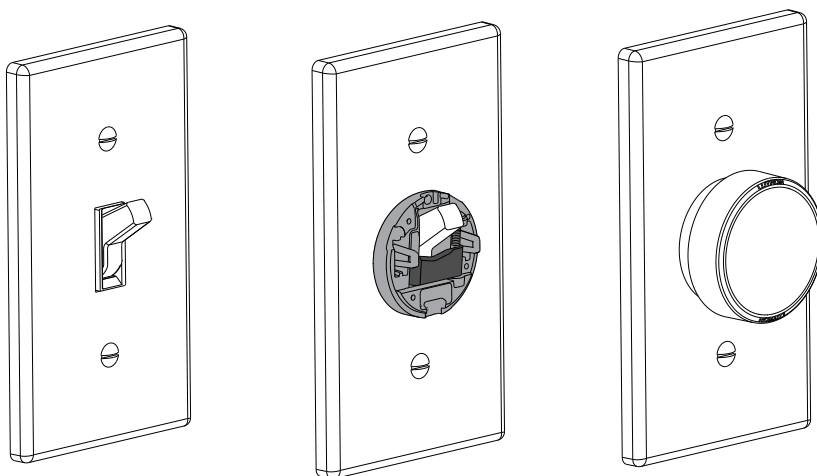

\* Only compatible with Philips® Hue® square-shape bridge V2. Not compatible with round-shape bridge V1.

\*\* Based on a 1 year shelf life, an average of 8 button presses per day, and an ambient temperature of 77 °F (25 °C). Actual life may vary based on usage and environmental conditions.

---

## aurora Always Ready Smart Bulb Dimmer

### Specifications

---

<b>Model Number</b>	Z3-1BRL-WH-L0
<b>Regulatory Approvals</b>	Lutron Quality Systems registered to ISO 9001:2015; FCC Certified (U.S.A.); IC Certified (Canada)
<b>Operating Voltage</b>	3 V <sup>===</sup> (1) CR2032 battery (included)
<b>Environment</b>	Ambient operating temperature: 50 °F to 104°F (10 °C to 40 °C). Maximum 90% relative humidity (non-condensing). Indoor use only.
<b>Communications</b>	Communicates using Radio Frequency (RF) at 2.4 GHz. Thousands of system addresses prevent interference between systems. The device is part of a Zigbee® mesh network. Range is dependent on density of the Zigbee® network and the devices that are being controlled.
<b>Mounting</b>	Mounting of any RF devices on or in close proximity to a metal surface may reduce the effective range of radio signal transmission or reception. For best performance, mount on non-metallic material.
<b>Warranty</b>	<a href="http://www.lutron.com/TechnicalDocumentLibrary/369-119_Wallbox_Warranty.pdf">http://www.lutron.com/TechnicalDocumentLibrary/369-119_Wallbox_Warranty.pdf</a>

---

# aurora Always Ready Smart Bulb Dimmer

## Model Number

Z3 – 1BRL – WH – LO

Button Configuration Code (1 Button with Raise/Lower)

Color Code (White)

Button Marking Code (no marking)

## Operation

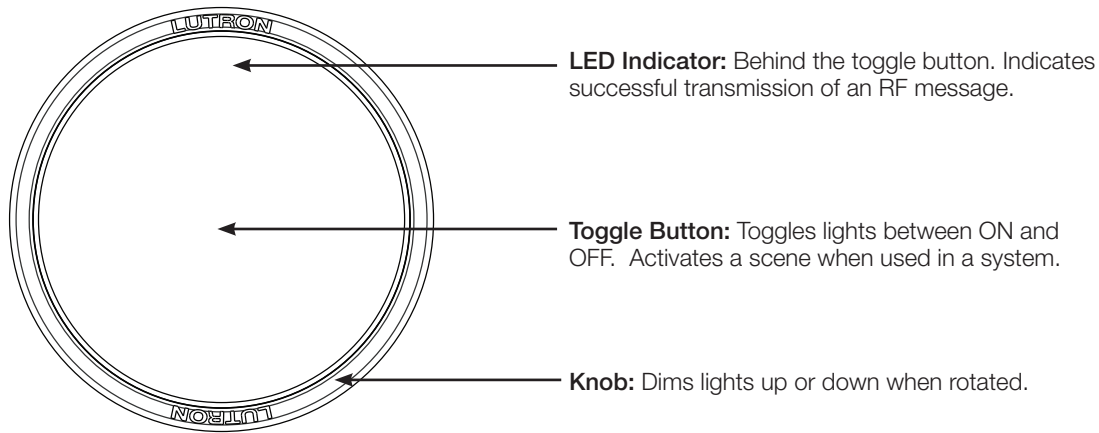

# aurora Always Ready Smart Bulb Dimmer

## Dimensions

All dimensions shown as: in (mm)

### Front View

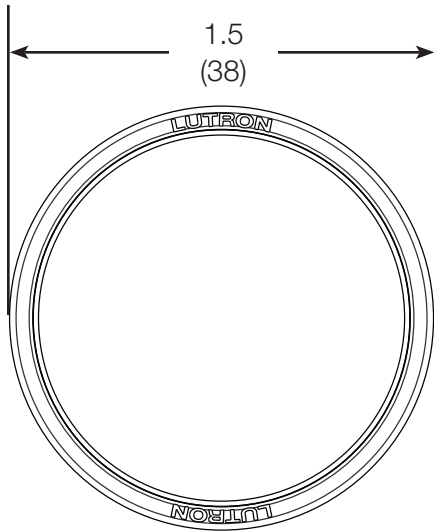

### Side View

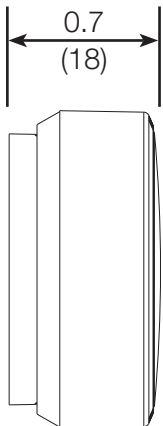

☀️ Lutron, Lutron and aurora are trademarks or registered trademarks of Lutron Electronics Co., Inc. in the US and/or other countries.  
Zigbee is a trademark of Zigbee Alliance.  
PHILIPS is a registered trademark of Koninklijke Philips N.V.  
Hue, Friends of Hue, and all related logos are trademarks of Signify Holding B.V. LLC.